

# PERKEMBANGAN GAMBAR ANAK

OLEH:

TITY SOEGIARTY

JURUSAN PENDIDIKAN SENI RUPA

FAKULTAS PENDIDIKAN BAHASA DAN SENI UNIVERSITAS  
PENDIDIKAN INDONESIA

2010

TAHAP GORESAN  
2 – 4 TAHUN

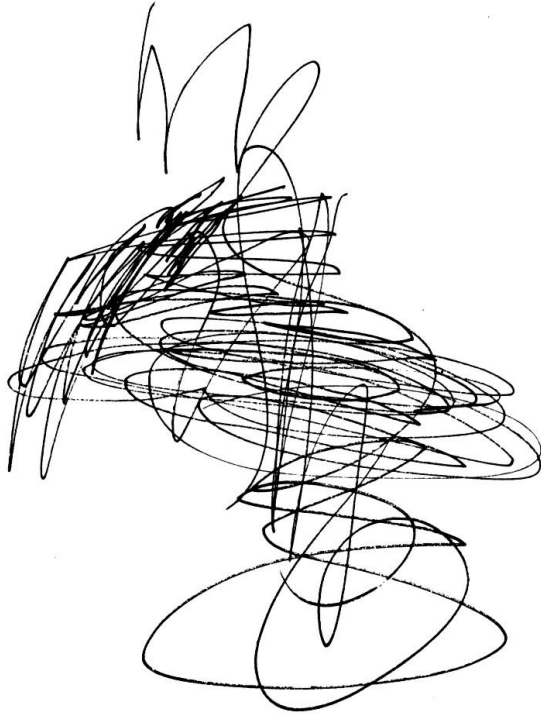

GORESAN TAK BERATURAN

## GORESAN TERKENDALI



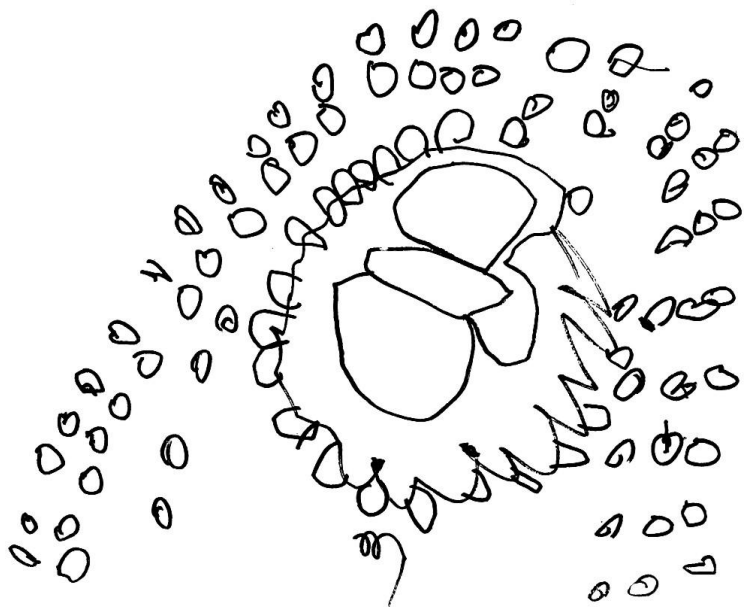

GORESAN BERMAKNA

MASA PRABAGAN  
4 – 7 TAHUN

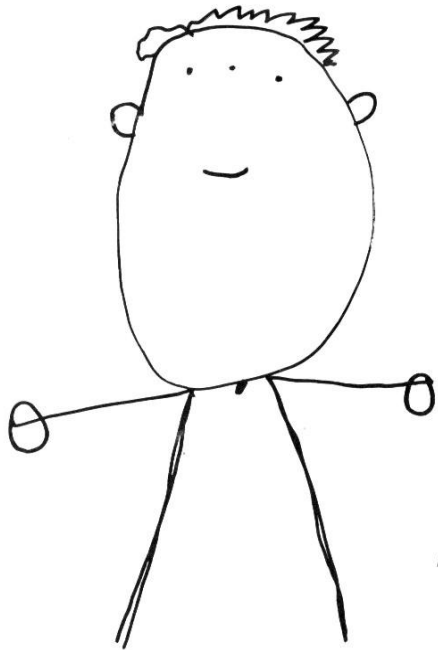

B

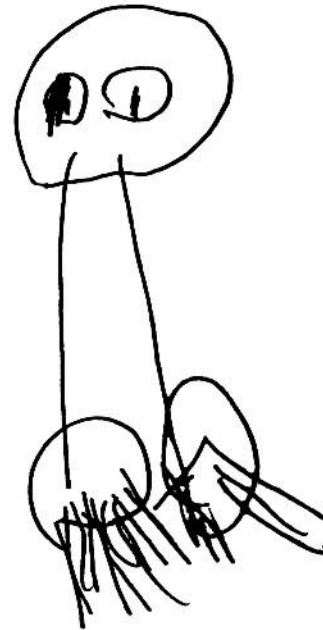

# MASA BAGAN 7 – 9 TAHUN

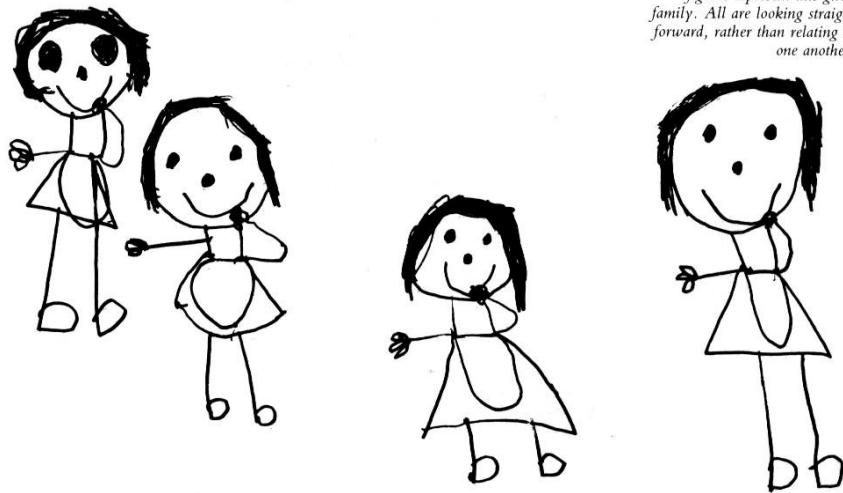

**Figure 117.**

*Four nearly identical schematic figures represent this girl's family. All are looking straight forward, rather than relating to one another.*

MASA REALISME  
9 – 12 TAHUN

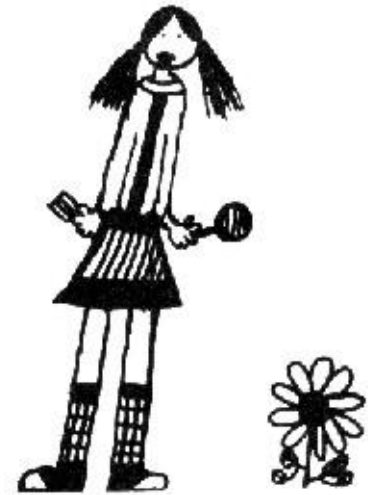
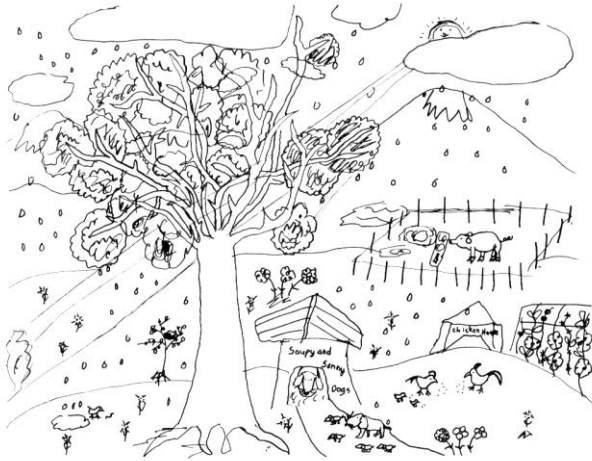

MASA NATURALISME SEMU  
12 – 14 TAHUN





MASA REMAJA  
14 -17 TAHUN



KEUNIKAN GAMBAR BUATAN  
ANAK-ANAK

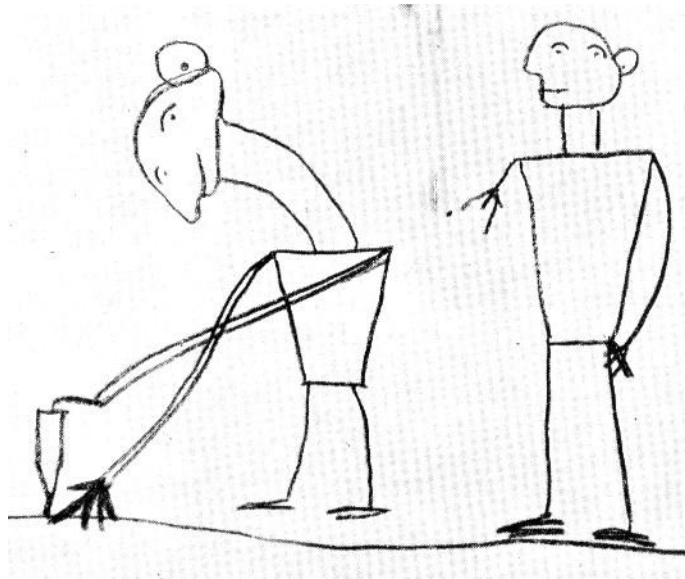

DOMINASI

# DOMINASI



# DOMINASI

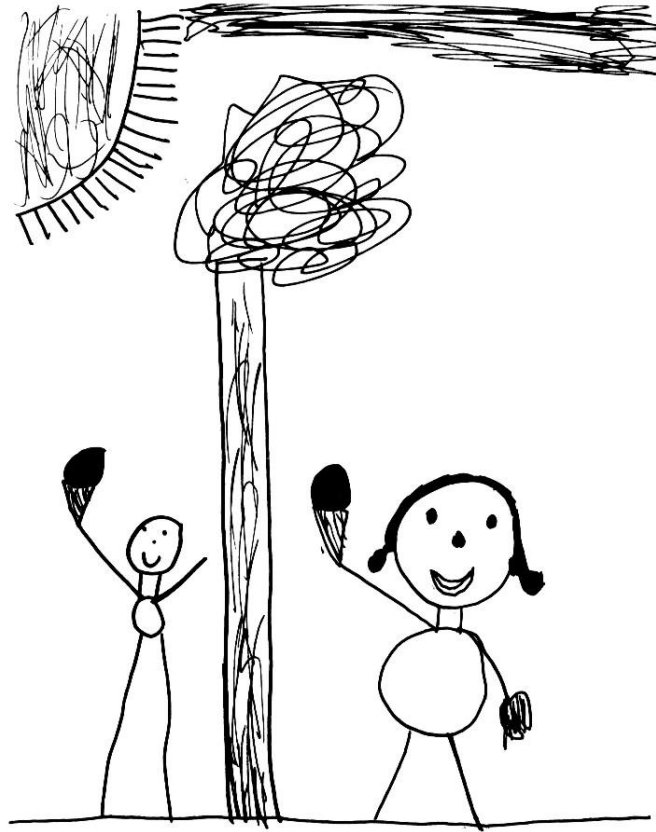

# IDEOPLASTIK

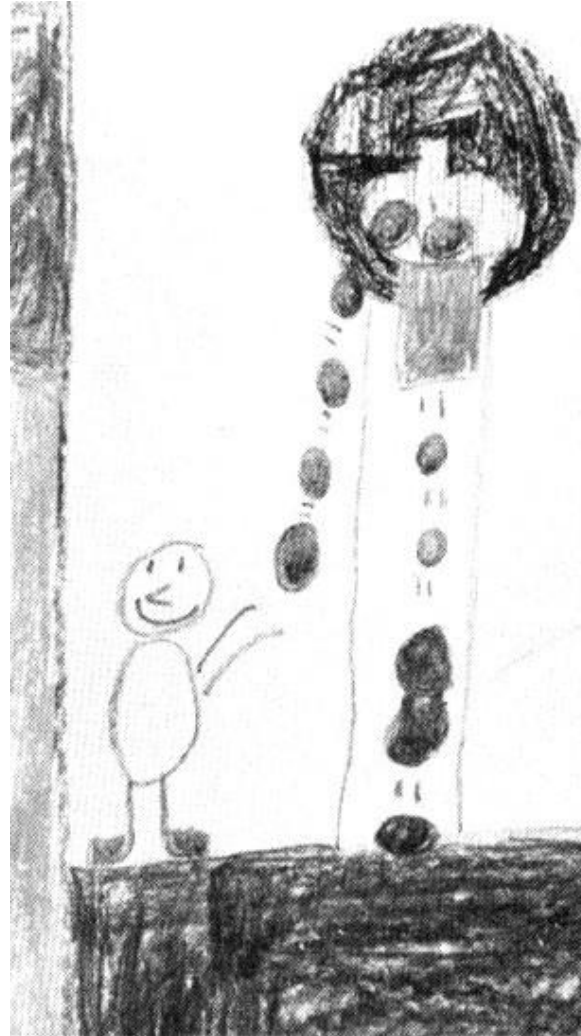

# X- RAY

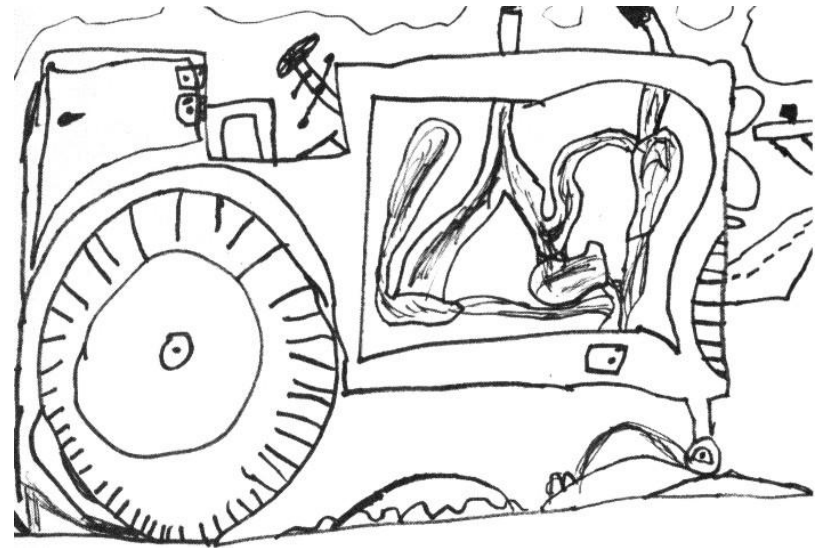
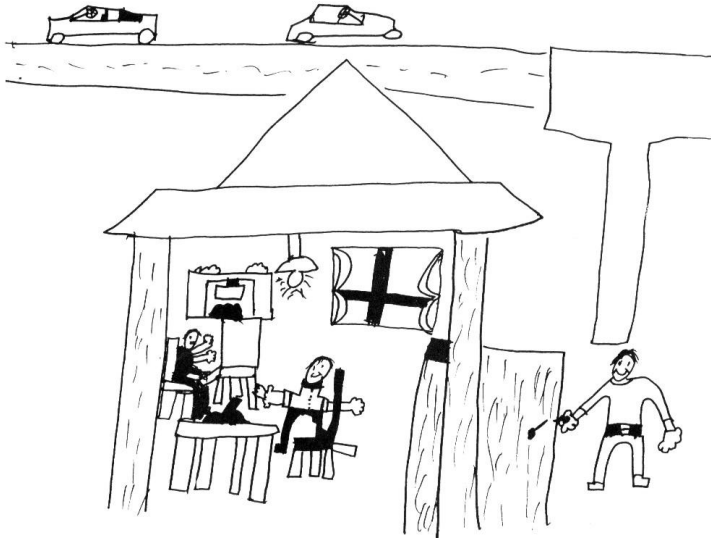

## KESAN RUANG PADA GAMBAR ANAK

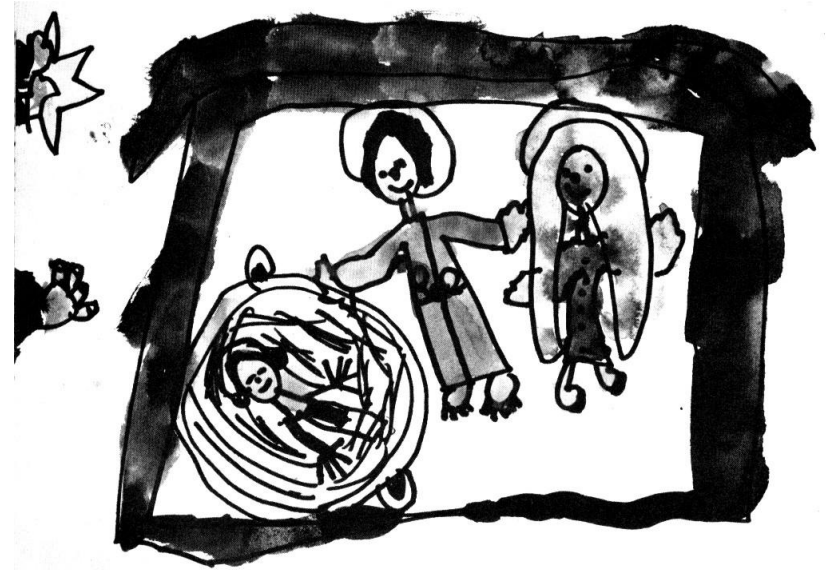
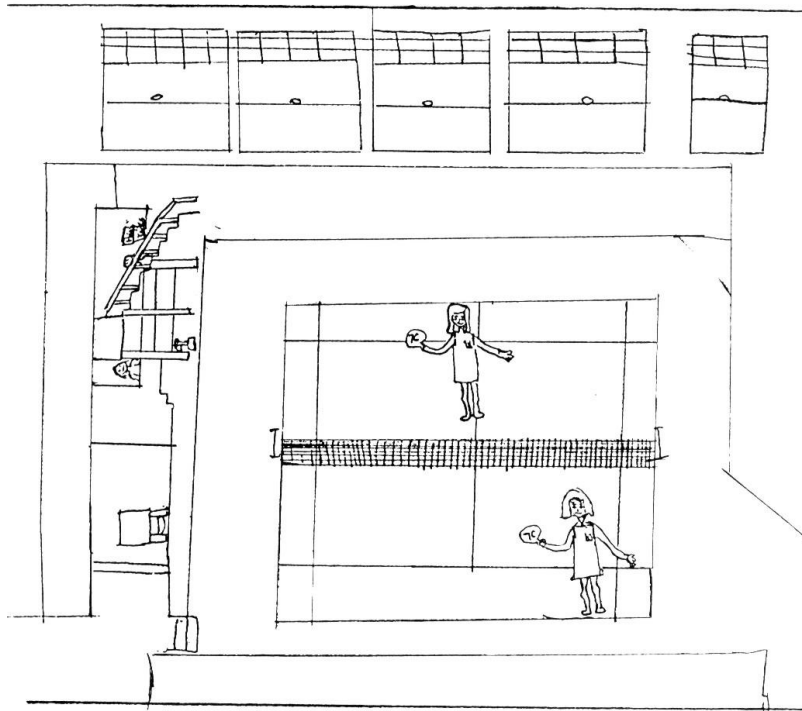

PERSPEKTIF BURUNG

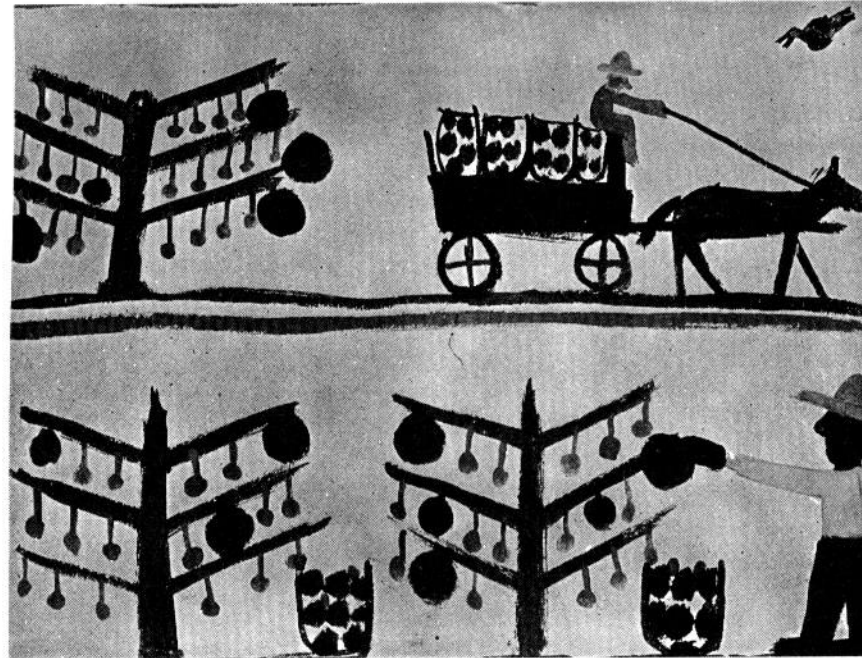

PENUMPUKAN



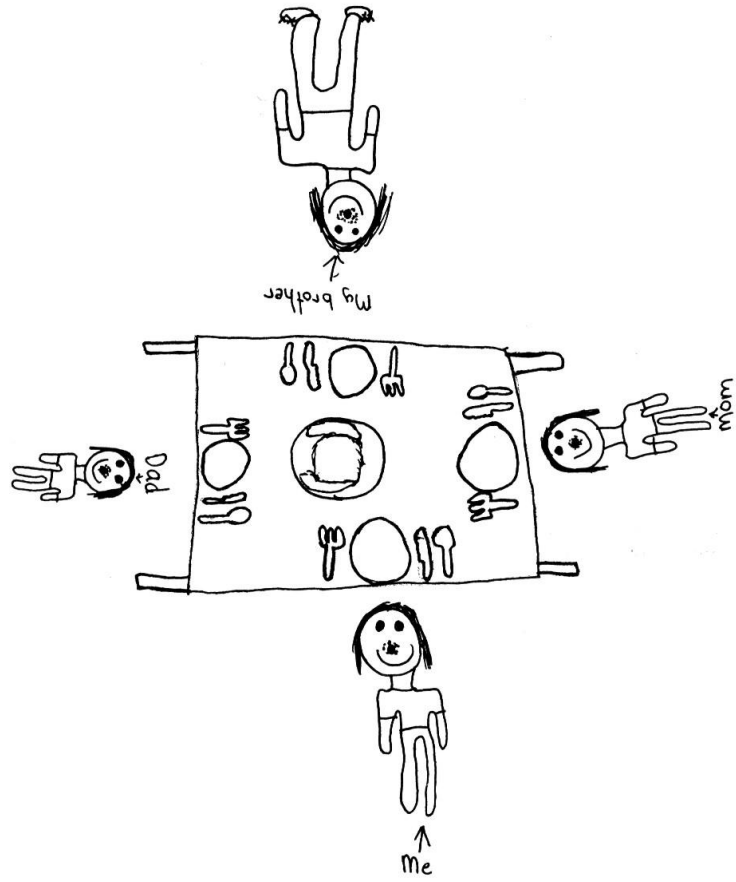

PEREBAHAN



TUTUP- MENUTUP

